

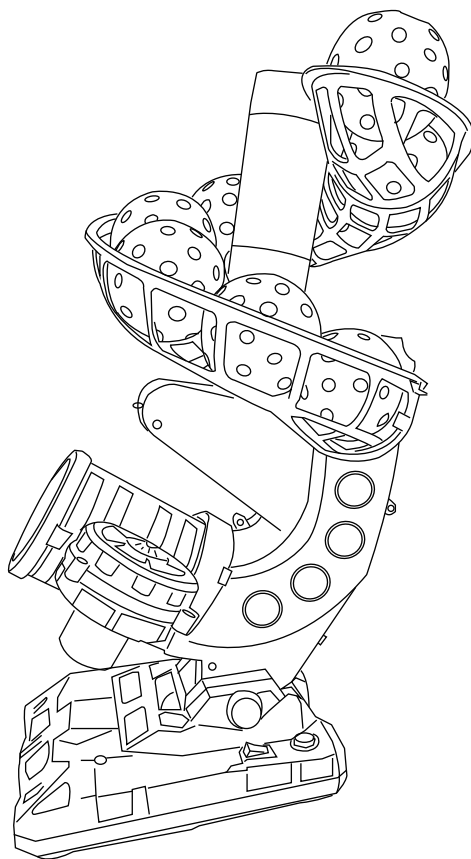

PICKLEBALL MACHINE

INSTRUCTION MANUAL

ZH-388PBH



Please read the user manual carefully before using this product and keep it properly.

CONTENT

PRECAUTIONS -----	1
SPECIFICATION -----	1
PARTS DESCRIPTION-----	2
PACKAGE CONTENT-----	2
INSTALLATION -----	3
MACHINE INSTALLATION-----	3
DRY BATTERIES INSTALLATION-----	4
FEATURES -----	6
BASIC TROUBLESHOOTING -----	7
WARRANTY & CUSTOMER SERVICE -----	8

PRECAUTIONS

Thank you very much for choosing Furlihong. Before using your Furlihong pickleball machine, please take a moment to review the following important safeguards to ensure safe and optimal operation:

- Do not use it in the rain or near dust or salt spray.
- Avoid getting the machine and battery box wet.
- Ensure the machine is used in a wide-open space of at least 15 meters.
- Children must play under adult supervision.
- Keep your face and hands away from the launcher when it's in use.
- Do not disassemble this product, as it may cause malfunction.
- Do not stand in front of the ball launcher when it's in operation.
- Do not place heavy objects on top of the machine.
- Use this product only for its intended purpose.
- Keep the machine away from high temperatures and fire.
- Wipe and clean the machine after each training session.

SPECIFICATION

Name	Pickleball Machine
Model	ZH-388PBH
Size	9" x 7" x 20"
Weight	7.4 lb
Rated Voltage	6V
Rated Power	15W

PARTS DESCRIPTION

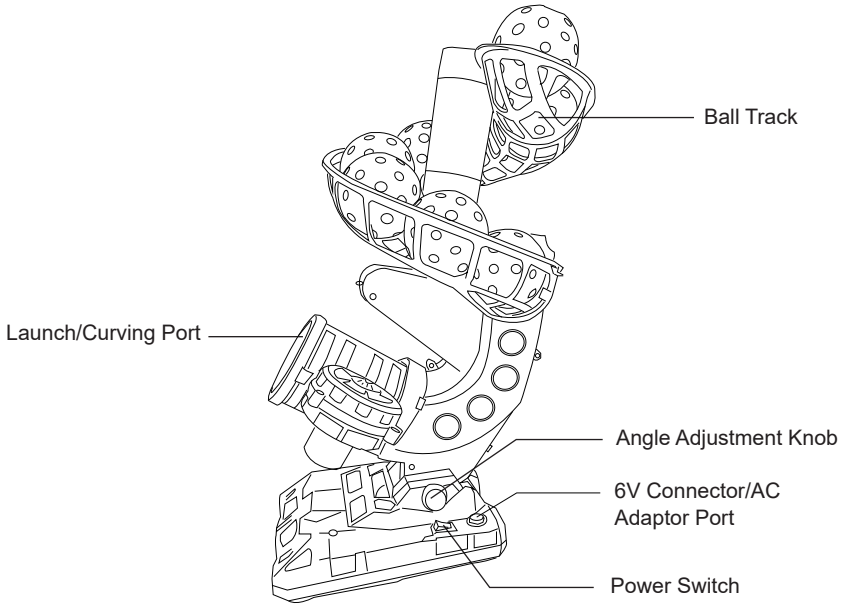

PACKAGE CONTENT

Machine x 1	Ball Tracks x 2	Top Track x 1
Pickleballs x 9	6V Connector x 1	Screw Driver x 1

Please make sure all parts are complete before use. If any items are missing or damaged, please contact us at services@furlihong.com.

INSTALLATION

MACHINE INSTALLATION

Note: Assembly of the machine must be performed by adults.

Note: Please gently squeeze the ball tracks if they are out of shape.

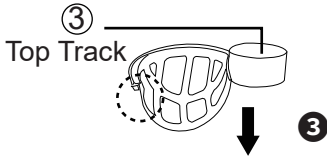
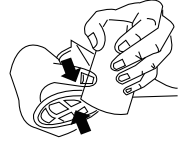

Step 3

Place the top track onto it, and ensure the ball tracks are firmly snapped into position.

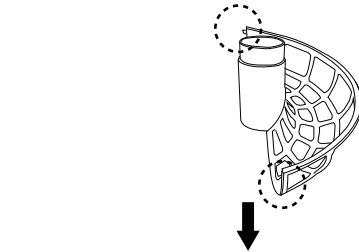

Step 2

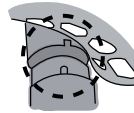

Assemble the ball tracks one and the other.



Ensure the ball tracks are firmly snapped into position.

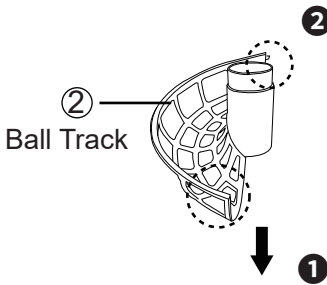

Step 1



Connect the ball track with the machine, and make sure it is completely connected.



Make sure the ball tracks are connected properly with the machine.



DRY BATTERIES INSTALLATION

- ✗ The battery box is at the bottom of the machine.
- ✗ Please turn off the machine before putting in the batteries.

1 Unscrew the lid with a screwdriver.

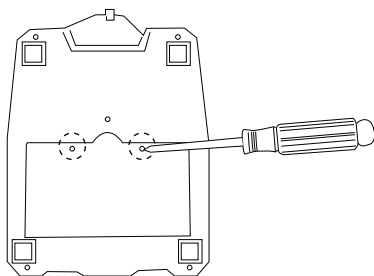

2 Please put batteries by following the positive and negative signs shown in the battery box. Close the lid and put the screws back.
(Need 4pcs of D-type dry batteries)

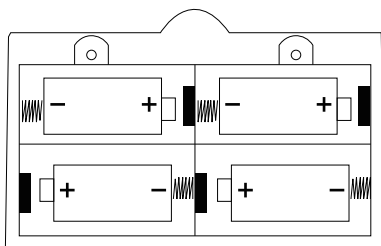

PRECAUTIONS FOR BATTERY INSTALLATION

- Battery installation must be performed by an adult.
- Do not mix different types of batteries.
- Do not mix new and old batteries.
- Remove batteries if the machine will not be used for an extended period.
- Ensure proper alignment of the '+' and '-' terminals.

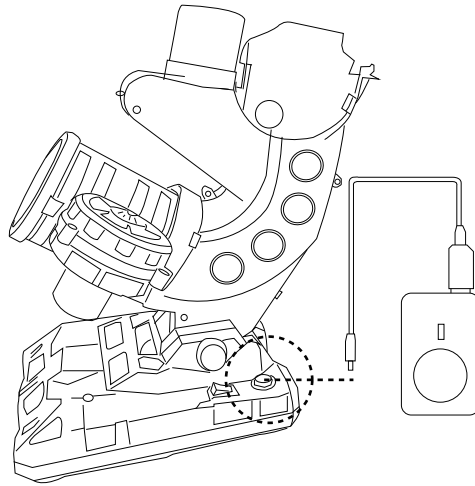

NOTE

If you choose to use a power bank to power the machine, please use the included 6V connector to connect the machine to the power bank.

- **The output of the power bank must be at least 2A.**

Tips for Use:

1. Use dry balls only; wet balls may cause the machine to malfunction.
2. Allow the machine to start and reach full speed before feeding the balls fully. Gradually increase from the lowest to the highest speed.
3. Insufficient power or voltage reduces launch height and distance.
Ensure proper power supply.
4. Ensure no balls are in the launcher before starting the machine, and turn it off before removing balls.

FEATURES

1 Curving Modes

By spinning the machine's launch port, the ball can curve left-hand side or right-hand side:

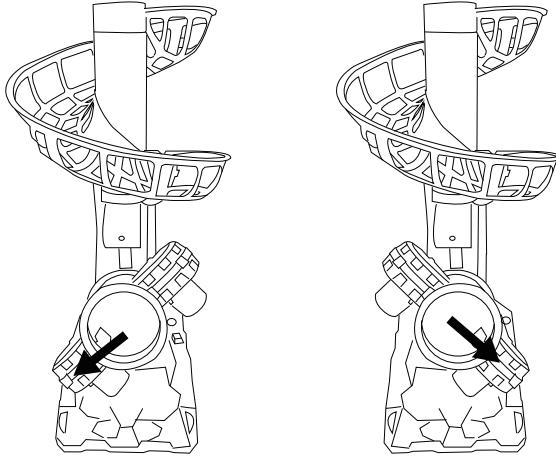

2 4 Angles Adjustable

Adjust the angle by pulling the knob, you could adjust the launch height of the machine.

NOTE

- Make sure the position is adjusted correctly before loosening the knob.
- If using battery power, the maximum distance may decrease.

- Serving height: 11 inch to 11 ft
- Serving distance: 16 ft to 52 ft

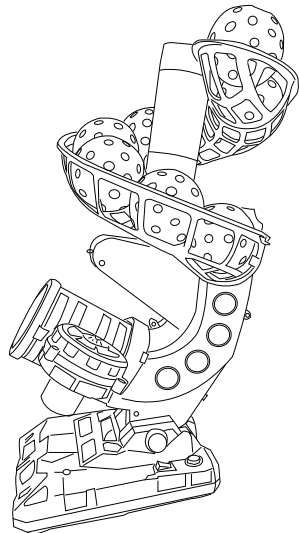

3 Tripod Connectivity

You can secure the machine on a camera tripod and adjust the height freely. The screw hole on the bottom of the machine is compatible with a standard camera tripod.

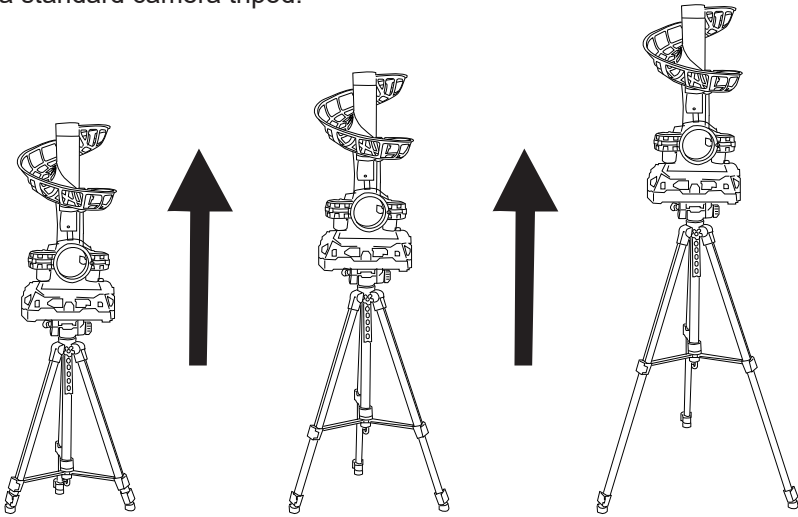

BASIC TROUBLESHOOTING

PROBLEMS	REASONS	SOLUTIONS
Doesn't drop ball.	Ball chutes not installed correctly.	Reinstall for full connection.
Power out.	Low batteries.	Replace with fresh ones.
Insufficient launch height/distance.	Inadequate machine power /voltage.	Ensure sufficient power/voltage.
	Machine setup issues.	Adjust the launch port angle.
Machine stops working.	Power issues	<ul style="list-style-type: none">• Battery: Replace batteries.• Power Bank: Verify if it is depleted.
	Other reasons.	Contact our customer service team.

WARRANTY & CUSTOMER SERVICE

We stand behind the quality of our products and are committed to providing exceptional customer service. Here's what you need to know about our warranty and how to reach us for assistance:

Warranty Coverage:

Your Furlihong pickleball machine is backed by a 12-month warranty against defects in materials and workmanship. This warranty ensures your satisfaction and peace of mind with your purchase.

Exclusions from Warranty Coverage:

The warranty does not cover damage caused by misuse, improper handling, or unauthorized modifications. Normal wear and tear is also not covered under the warranty.

How to Submit a Warranty Claim:

If you encounter any issues covered under warranty, please reach out to our customer service team at services@furlihong.com. To expedite your claim, provide proof of purchase and a detailed description of the issue.

Customer Service:

For any questions, concerns, or assistance with your Furlihong pickleball machine, our customer service team is here to help. You can contact us via email at services@furlihong.com

Stay connected with us for updates and more! Follow our brand on social media:



@furlihongsports



@furlihong





 www.furlihong.com

 services@furlihong.com

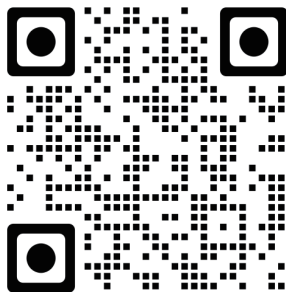

Scan the QR code to access the website instantly.