

■ Parts list Kindly be sure all parts fine before assembling

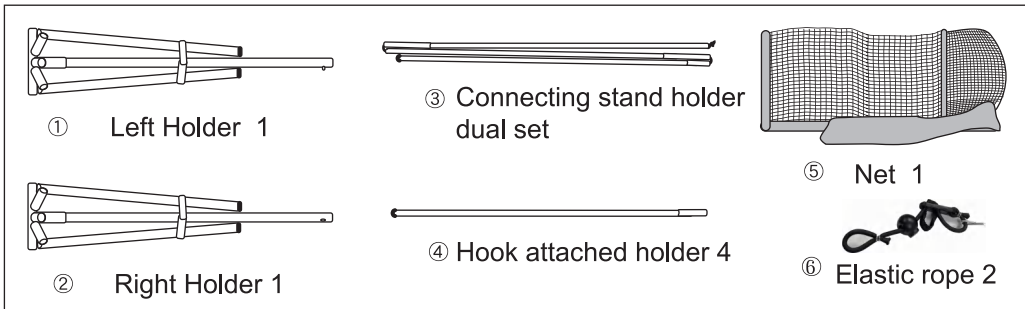

※ All iron poles might have scratching appearance due to delivery issue. It won't bring negative effects. Please do not worry.

■ Installation instruction Assemble on flat surface with adult's supervision.

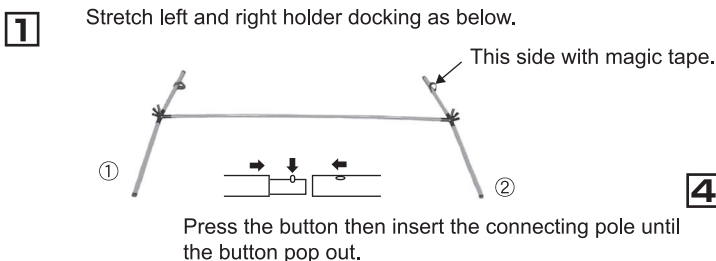

※ Beware your fingers while assembly.

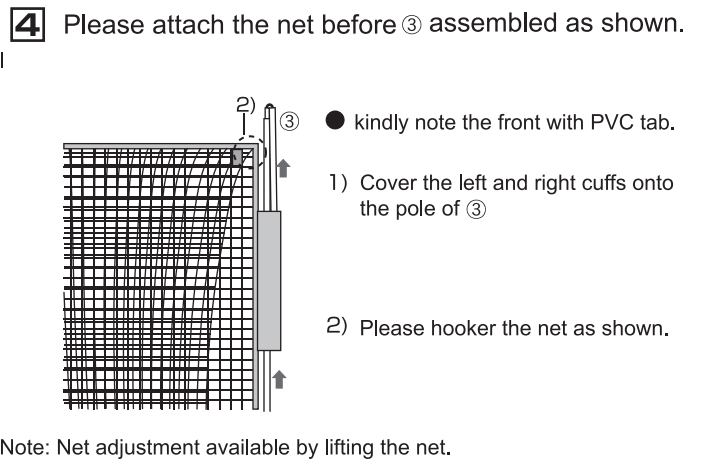
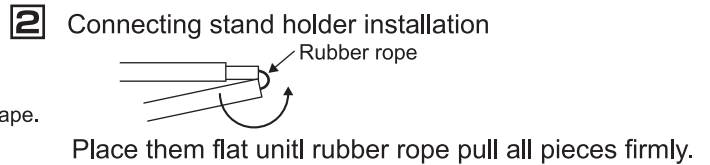
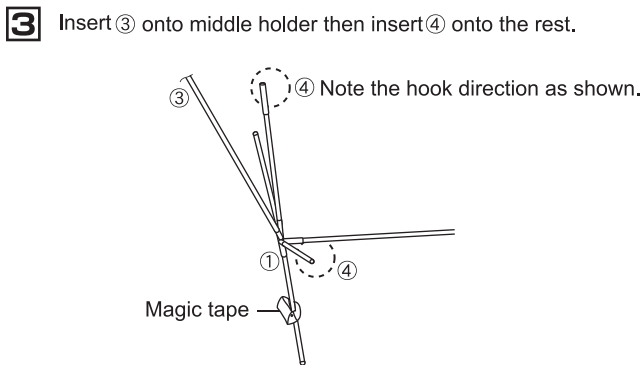

5 Attach the Net as shown.

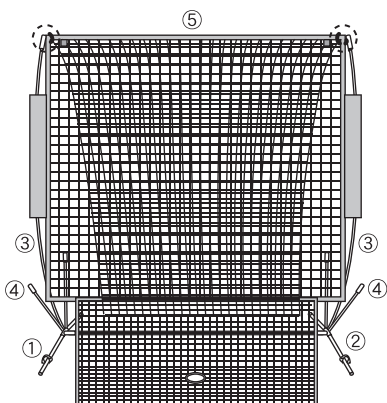

6 Attach the net of bottom by hooking.



● Feel free to stretch the net if it's too loose.

7 Use the magic tape to tie up the stand holder.

Attach both side of net. ● Stretch gently the net and see the tightness.

8 Stop Net

■ Stop holder installation

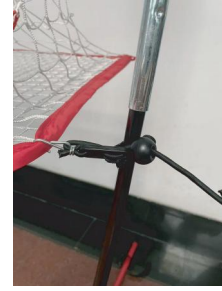

Please use ⑥ to tie to between the stop net and the connecting stand holder.

9 Place unit

■ Place ZH-6801BH underneath the hole.

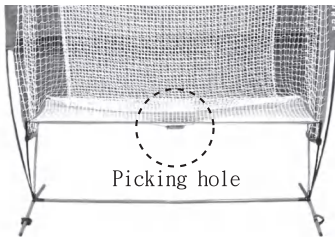

Picking hole

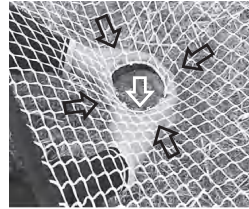

● The unit adjustment

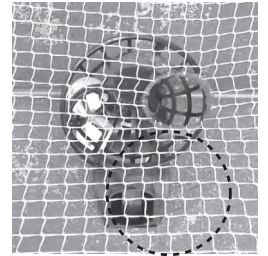

Align the top of carriage onto the hole.

● Hole adjustment

Make the loop smoothly by grabbing the pipe with net.

Note: Please align the wall or find cease objects to stop the net holder due to the vibrate while playing.

■ Technical Details:

Item dimensions L x W x H: 69*82.7*40.2 inches

Weight: 4.2 Kilograms

Materail: Holder/iron, Hook attache holder/fiberglass

Net/Polyster

Please follow the instruction as below.

⚠ NOTE

- Adult assembly and supervision required.
- Do not assemble or play in the strong wind environment.
- Please storage well once session finished.
- Do not climb or pulled rudely the product.

⚠ Product instruction

- Do not pull the rubber rope rudely.
- Please use it on flat surface and open ground.
- Please don't lay too many balls on net and storage the net when session finished in order to keep the tension.
- Please use it on dry environment.
- Please use the official balls for playing
- Please clean and storage well the product after session finished. Keep it away from mositure and high temperature environments.

MADE IN CHINA